

Thank you for purchasing this Dynojet kit. This kit has been developed for a motorcycle which is set to the parameters listed at the right in the "Stage" description. If your motorcycle does not meet any of these parameters please check with Dynojet before installation. For technical assistance contact your Dynojet distributor or call Dynojet U.S.A. (800)-992-4993

2191 Mendenhall Dr. Suite 105  
 North Las Vegas, NV 89031  
 TEL: 702-399-1423  
 FAX: 702-399-1431  
 8am-5pm Pacific Time  
 Monday through Friday

Website Address  
<http://www.dynojet.com>

The manufacturer and seller make no warranties express or implied which extend beyond the description of the goods contained herein. Any description of this product is for the purpose of identifying it and shall not be deemed to create an express warranty.



**2176.001**  
 U.S. Models Only  
 1999-02 Kawasaki W650  
 Stage 1

For mildly tuned machines using the stock airbox, with stock or K&N filter. May also be used with a good aftermarket exhaust system  
 K&N filter # N/A

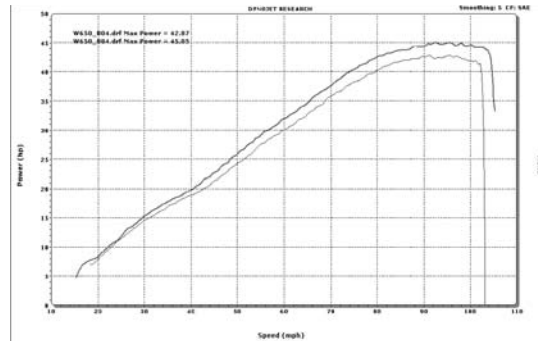

*This graph shows a typical gain with a Dynojet jet kit.*

# WARNING

**NO SMOKING!  
 NO OPEN FLAME!  
 WHILE INSTALLING  
 YOUR DYNOJET KIT**

Parts List		
2	Main Jets	DJ106
2	Main Jets	DJ108
2	Main Jets	DJ110
2	Main Jets	DJ112
2	Main Jets	DJ114
2	Fuel Needles	DNO119
2	Slide Springs	DSP005
4	Adjusting Washers	DW0001
2	E-Clips	DE0001
1	Plug Drill	DD 5/32
1	Screw	DS0001

## STAGE ONE INSTRUCTIONS

1. Remove the vacuum slide from the carbs. Remove the stock needles & spacers, noting the order of assembly.
2. Install the Dynojet needles on groove # 2, using all stock spacers (Fig. A). Install the adjusting washers above the e-clip (2 per needle). Install the Dynojet slide springs (DSP005) in place of the stock slide springs.
3. Remove the main jet and replace with the Dynojet main jets provided. Use the DJ108 main jets with stock exhaust. Use the DJ112 main jets with aftermarket headers or slip-ons with free flowing baffles. Be sure that the jets you are changing are the main jets.
4. Locate the fuel mixture screw (Fig. B). If you see a screw head, proceed to adjusting procedure. With the plug drill (DD #5/32) provided, carefully drill thru the plugs. NOTE: The mixture screw is directly underneath this plug, be ready to pull back on the drill the instant you break thru. Use screw provided to secure and remove the plug. Carefully turn mixture screw clockwise until seated, then back out 3 turns.

Fig. A

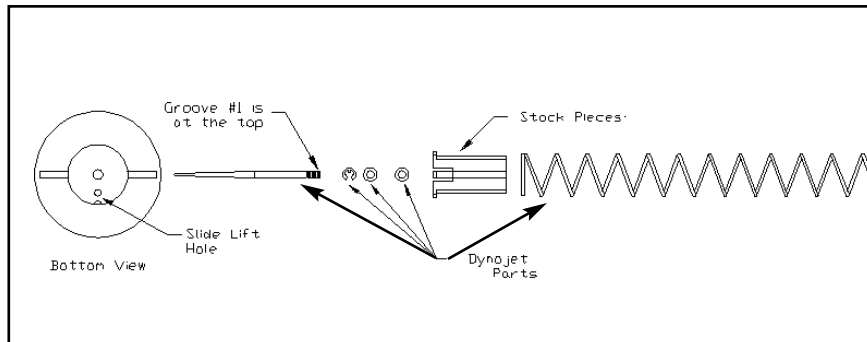
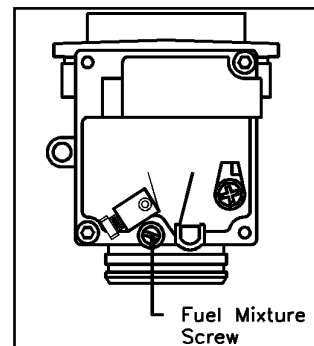

Fig. B



Place E-clip in groove #2 from the top

