

Thank you for purchasing this Dynojet kit. This kit has been developed for a motorcycle which is set to the parameters listed at the right in the "Stage" description. If your motorcycle does not meet any of these parameters please check with Dynojet before installation. For technical assistance contact your Dynojet distributor or call Dynojet U.S.A. (800)-992-4993

2191 Mendenhall Dr. Suite 105
 North Las Vegas, NV 89081
 TEL: 702-399-1423
 FAX: 702-399-1431
 8am-5pm Pacific Time
 Monday through Friday

Website Address
<http://www.dynojet.com>

The manufacturer and seller make no warranties express or implied which extend beyond the description of the goods contained herein. Any description of this product is for the purpose of identifying it and shall not be deemed to create an express warranty.



4145.001

U.S Models Only

1997-2007 Yamaha YZF600R

Stage 1

For mildly tuned machines using the stock airbox, with stock filter. May also be used with a good aftermarket exhaust system

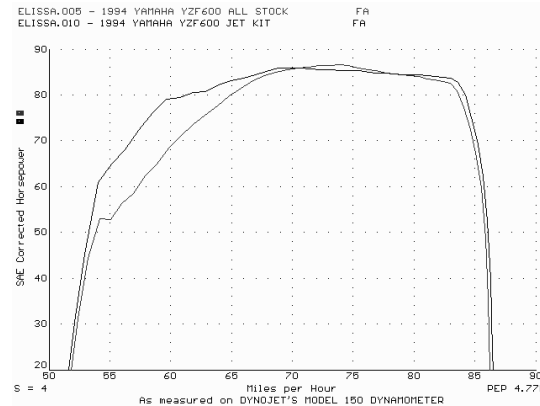

This graph shows a typical gain with a Dynojet jet kit.

WARNING

**NO SMOKING!
 NO OPEN FLAME!
 WHILE INSTALLING
 YOUR DYNOJET KIT**

Parts List		
4	Main Jets	DJ140
4	Main Jets	DJ144
4	Main Jets	DJ150
4	Fuel Needles	DNO348
4	E-clips	DE0001
8	Adjusting Washers	DW0001
4	Slide Spring	DSP026
1	Plug Drill	DD 5/32
1	Screw	DS0001

STAGE ONE INSTRUCTIONS

Dynojet

4145.001

1. Remove the vacuum slides from the carbs. Remove the stock needles and spacers, noting the order of assembly(Fig.A).
2. Install the Dynojet needles on groove #4 from the top. Use all stock spacers (Fig. A). Install the small Dynojet washers above the E-clip (2 per needle). Install the Dynojet slide springs (DSP026) in place of the stock slide springs. After installing the slides in the carbs be sure to check slide movement manually.
3. Remove the stock main jets and replace with the Dynojet main jets provided. If you are running the stock exhaust install the DJ144 main jets. If you are running an aftermarket exhaust or slip-on with high flow baffle use the DJ150 main jets. Be sure that the jets you are changing are the main jets. **NOTE: If running above 4000ft use the DJ140 main jets with the stock exhaust and the DJ144 main jets with an aftermarket exhaust.**
4. Locate the fuel mixture plug (Fig. B). If you see a screw head at Fig. B then proceed to the adjusting procedure. With the DD #5/32 drill bit provided, carefully drill through the plug. **NOTE: The mixture screw is directly underneath this plug, be ready to pull back on the drill the instant you break through.** Use screw provided to secure and remove this plug. Carefully turn the mixture screws clockwise until lightly seated, then back out 2-1/2 turns.

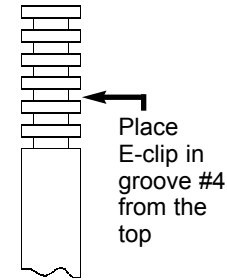

Fig. A

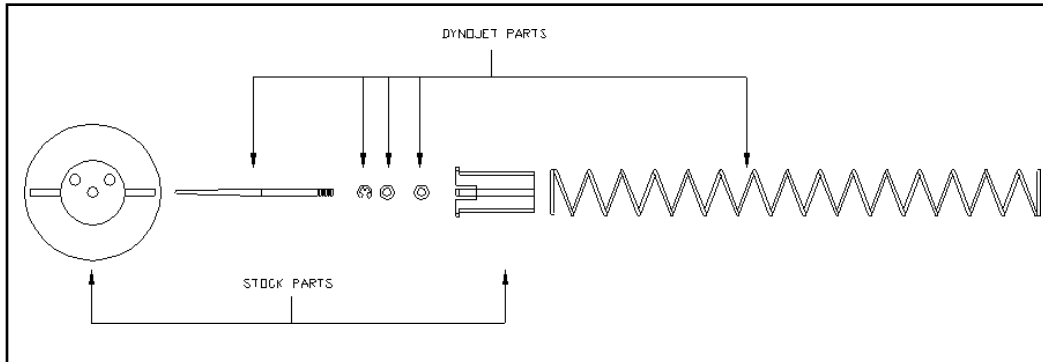

Fig. B

