

Thank you for purchasing this Dynojet kit. This kit has been developed for a motorcycle which is set to the parameters listed at the right in the "Stage" description. If your motorcycle does not meet any of these parameters please check with Dynojet before installation. For technical assistance contact your Dynojet distributor or call Dynojet U.S.A. (800)-992-4993

2191 Mendenhall Dr. Suite 105  
 North Las Vegas, NV 89031  
 TEL: 702-399-1423  
 FAX: 702-399-1431  
 8am-5pm Pacific Time  
 Monday through Friday

Website Address  
<http://www.dynojet.com>

The manufacturer and seller make no warranties express or implied which extend beyond the description of the goods contained herein. Any description of this product is for the purpose of identifying it and shall not be deemed to create an express warranty.



**E1102.001**

European Models Only

*1997-99 Honda SLR 650 Vigor*

**Stage 1**

For mildly tuned machines using the stock airbox, with stock filter. May also be used with a good aftermarket exhaust system.  
 K&N filter #N/A.

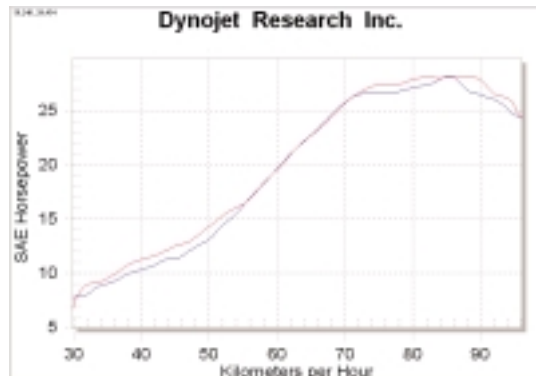

*This graph shows a typical gain with a Dynojet jet kit.*

# WARNING

**NO SMOKING!  
 NO OPEN FLAME!  
 WHILE INSTALLING  
 YOUR DYNOJET KIT**

<b>Parts List</b>		
1	Main Jet	DJ155
1	Main Jet	DJ160
1	Main Jet	DJ165
1	Fuel Needle	DNO640M
1	Adjusting Washer	DW0001
1	E-Clip	DE0001

## STAGE ONE INSTRUCTIONS

**DYNOJET**

**E1102.001**

1. Remove the vacuum slide from the carbs. Remove the stock needles & spacers, noting the order of assembly (Fig. A).
2. Install the Dynojet needles on groove #2, using all stock spacers. Install the Dynojet washer above the E-clip.
3. Remove the stock main jet and replace with Dynojet main jet provided. If you are running the stock exhaust use the DJ160 main jet, if you are running an aftermarket header or slip-on with high flowing baffle, use the DJ165 main jet. The DJ155 main jet is included for high altitude applications. Be sure that the jet you are changing is the main jet.
4. Locate the fuel mixture screw (Fig. B). Carefully turn mixture screws clockwise until lightly seated, turn out 3 turns.

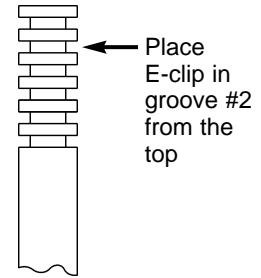

Fig. A

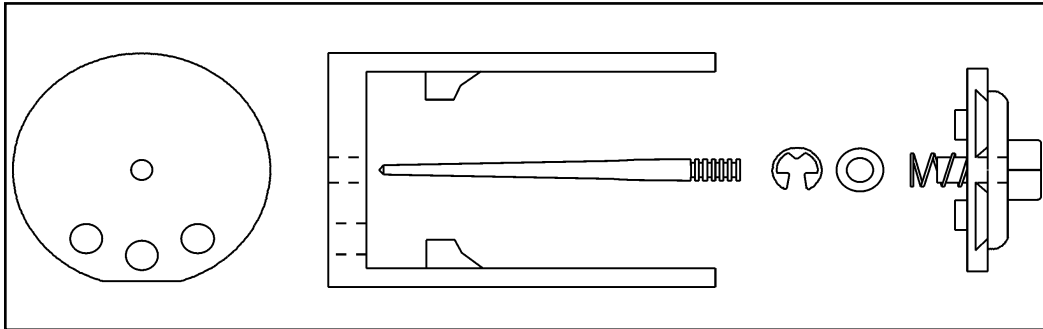

Fig. B

