

Thank you for purchasing this Dynojet kit. This kit has been developed for a motorcycle which is set to the parameters listed at the right in the "Stage" description. If your motorcycle does not meet any of these parameters please check with Dynojet before installation. For technical assistance contact your Dynojet distributor or call Dynojet U.S.A. (800)-992-4993



E1144.002

European Models Only

1990-95 Honda NX650

Stage 1

For mildly tuned machines using the stock air-box, with stock or K&N filter. May also be used with a good aftermarket exhaust system
K&N filter #NA

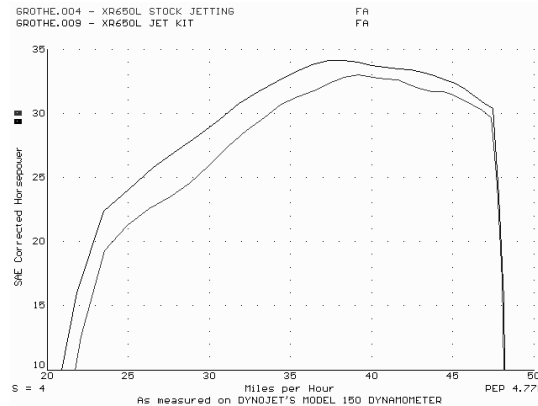

This graph shows a typical gain with a Dynojet jet kit.

WARNING

**NO SMOKING!
NO OPEN FLAME!
WHILE INSTALLING
YOUR DYNOJET KIT**

2191 Mendenhall Dr. Suite 105
North Las Vegas, NV 89081
TEL: 702-399-1423
FAX: 702-399-1431
8am-5pm Pacific Time
Monday through Friday

Website Address
<http://www.dynojet.com>

The manufacturer and seller make no warranties express or implied which extend beyond the description of the goods contained herein. Any description of this product is for the purpose of identifying it and shall not be deemed to create an express warranty.

Parts List		
1	Main Jet	DJ150
1	Main Jet	DJ160
1	Main Jet	DJ165
1	Fuel Needle	DNO103
1	Slide Drill	DD 5/32
1	Needle Jet Shroud	DNJT02
1	E-clip	DE0001
1	Adjusting Washer	DW0001
1	Glue	DA0001
1	Air Box Mod Insert	DIG NX650

STAGE ONE INSTRUCTIONS

1. Remove the vacuum slide from the carbs. Remove the stock needles & spacers, noting the order of assembly. Using the slide drill (DD# 5/32) provided, drill your slide lift holes (Fig. A), the picture may not show your slide exactly. Drill your existing slide lift holes only, do not drill any new holes and do not drill the needle hole.
2. Install the needle shrouds (DNJT02) with the cutaway facing up and towards the engine (Fig. B). Slip the shroud slightly over the stock needle jet and hold, now touch a dab of glue on the outer base of the stock needle jet. Press needle shroud down and allow to dry thoroughly. Check for any visible excess glue.
3. Install the Dynojet needles on groove #3, using all stock spacers (Fig. A). Install the Dynojet washer above the E-clip.
4. Remove the main jets and replace with the Dynojet main jets provided. Use the DJ160 main jets with stock exhaust, or use the DJ165 main jets with aftermarket header or slip-on with a high flowing baffles. Be sure that the jets you are changing are the main jets.
5. Locate the fuel mixture screw (Fig. C). Carefully turn mixture screw clockwise until seated, then back out 3 turns.

Dynojet

E1144.002

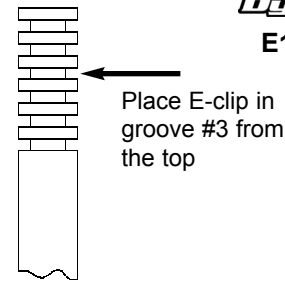

Fig. B

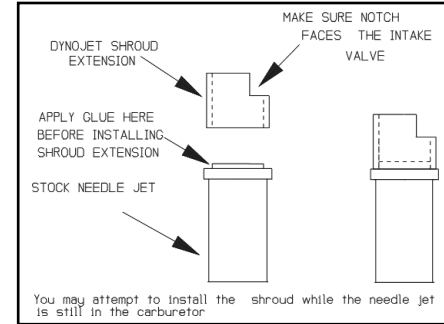

Fig. A

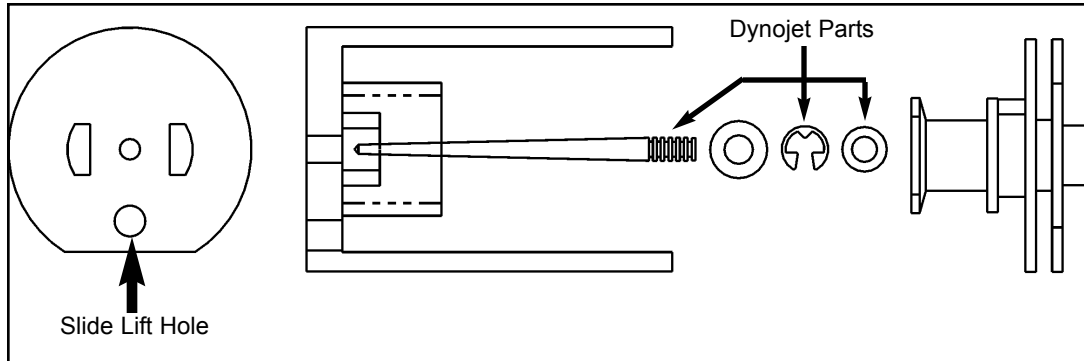
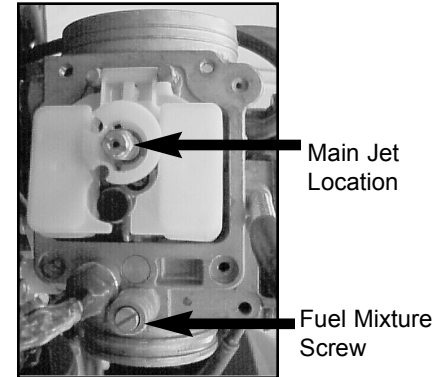
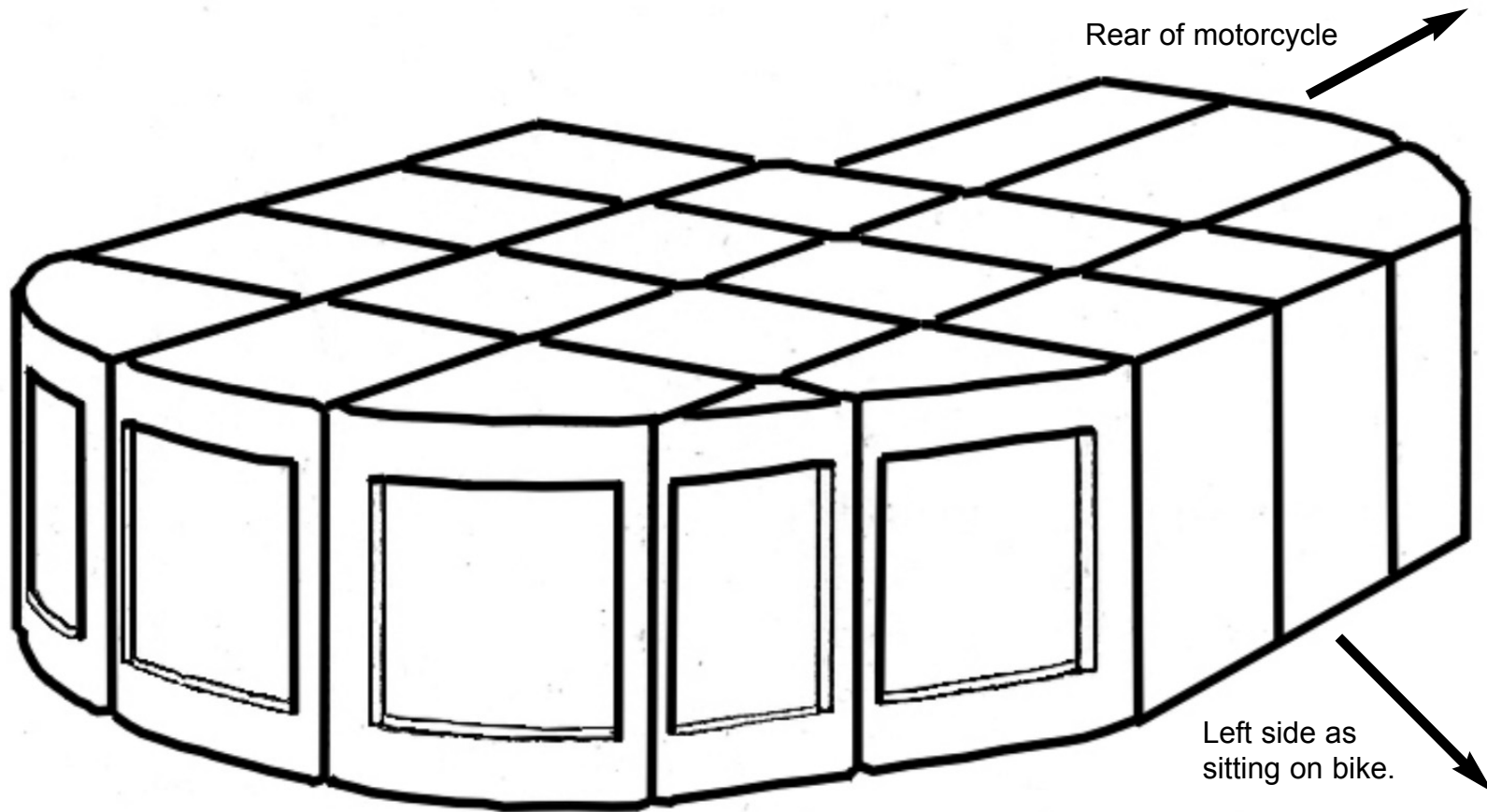

Fig.C



DIG NX650



**Cut out 5 rectangle holes with a sharp razor blade.
Stay between heavy molded ridges.**