

Thank you for purchasing this Dynojet kit. This kit has been developed for a motorcycle which is set to the parameters listed at the right in the "Stage" description. If your motorcycle does not meet any of these parameters please check with Dynojet before installation. For technical assistance contact your Dynojet distributor or call Dynojet U.S.A. (800)-992-4993

2191 Mendenhall Dr. Suite 105  
 North Las Vegas, NV 89031  
 TEL: 702-399-1423  
 FAX: 702-399-1431  
 8am-5pm Pacific Time  
 Monday through Friday

Website Address  
<http://www.dynojet.com>

The manufacturer and seller make no warranties express or implied which extend beyond the description of the goods contained herein. Any description of this product is for the purpose of identifying it and shall not be deemed to create an express warranty.



**E2139.002**

European Models Only

*1987 Kawasaki 1000 Eliminator*

**Stage 1&3**

**STAGE 1**

For mildly tuned machines using the stock airbox, with stock or K&N filter #N/A

**STAGE 3**

For mildly tuned machines using individual filters or velocity stacks. K&N filters #RC-0984

**Both stages may be used with a good aftermarket exhaust**

SPECIALS.002 - ZX1000R STOCK JETTING AFTERMARKET PIPERO  
 SPECIALS.008 - ZX1000R JET KIT AFTERMARKET PIPE RO

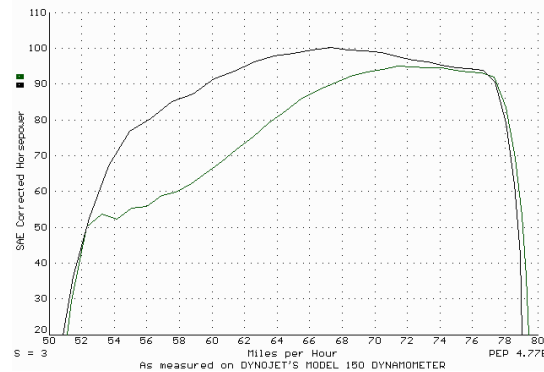

*This graph shows a typical gain with a Dynojet jet kit.*

**WARNING**

**NO SMOKING!  
 NO OPEN FLAME!  
 WHILE INSTALLING  
 YOUR DYNOJET KIT**

Parts List		
4	Main Jets	DJ122
4	Main Jets	DJ126
4	Main Jets	DJ136
4	Main Jets	DJ140
1	Slide Drill	DD# 31
4	Fuel Needles	DNO106
8	Adjusting Washers	DW0001
4	E-Clips	DE0001
4	Slide Springs	DSP005

**STAGE ONE INSTRUCTIONS**

1. Remove the vacuum slide from the carbs. Remove the stock needles & spacers, noting order of assembly.
2. Using the slide drill (DD #31) provided, drill your slide lift hole (Fig. A). The picture may not show your slide exactly. Drill your existing slide lift hole only, do **not** drill any new holes and do **not** drill the needle hole.
3. Install Dynojet needles on groove #3, using all stock spacers (Fig. A). Install the Dynojet washers above the E-clip (2 per needle) .
4. Install the Dynojet slide springs in place of the stock slide springs.
5. Remove the main jet and replace with the Dynojet main jets provided. Use the DJ122 main jets with stock exhaust pipe, or use the DJ126 main jets with aftermarket header or slip-on with high flowing baffles. Be sure that the jets you are changing are the main jets.
6. Locate the Fuel Mixture Screw (Fig. B). Carefully turn mixture screw clockwise until seated, then back out until you find your best idle. Our base setting is 3 turns.

**STAGE THREE INSTRUCTIONS**

1. Remove the vacuum slide from the carbs. Remove the stock needles & spacers, noting order of assembly.
2. Using the slide drill (DD #31) provided, drill your slide lift hole (Fig. A). The picture may not show your slide exactly. Drill your existing slide lift hole only, do **not** drill any new holes and do **not** drill the needle hole.
3. Install Dynojet needles on groove #3, using all stock spacers (Fig. A). Install the Dynojet washers above the E-clip (2 per needle).
4. Install the Dynojet slide springs in place of the stock slide springs.
5. Remove the main jet and replace with the Dynojet main jets provided. Use the DJ136 main jets with stock exhaust pipe, or use the DJ140 main jets with aftermarket header or slip-on with high flowing baffles. Be sure that the jet you are changing is the main jet.
6. Locate the Fuel Mixture Screw(Fig. B). carefully turn mixture screw clockwise until seated, then back out until you find your best idle. Our base setting is 3 turns.

Fig. A

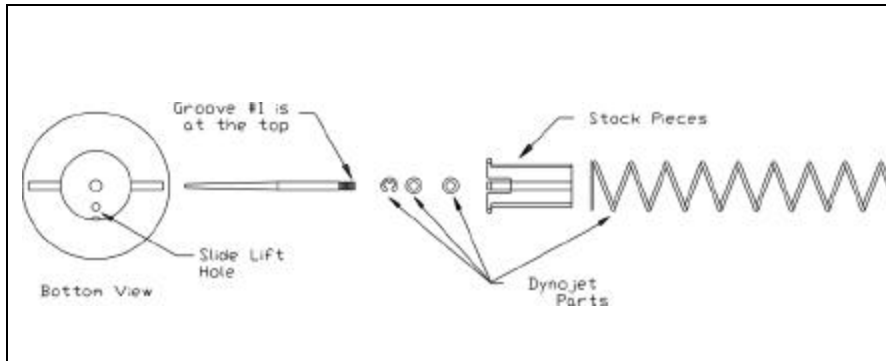

Fig. B

