

Thank you for purchasing this Dynojet kit. This kit has been developed for a motorcycle which is set to the parameters listed at the right in the "Stage" description. If your motorcycle does not meet any of these parameters please check with Dynojet before installation. For technical assistance contact your Dynojet distributor or call Dynojet U.S.A. (800)-992-4993

2191 Mendenhall Dr. Suite 105
 North Las Vegas, NV 89031
 TEL: 702-399-1423
 FAX: 702-399-1431
 8am-5pm Pacific Time
 Monday through Friday

Website Address
<http://www.dynojet.com>

The manufacturer and seller make no warranties express or implied which extend beyond the description of the goods contained herein. Any description of this product is for the purpose of identifying it and shall not be deemed to create an express warranty.



E2170.001

European Models Only

1996-98 Kawasaki ZX-7R

Stage 1

For mildly tuned machines using the stock air-box, with stock or K&N filter. May also be used with a good aftermarket exhaust system K&N filter #KA-0016

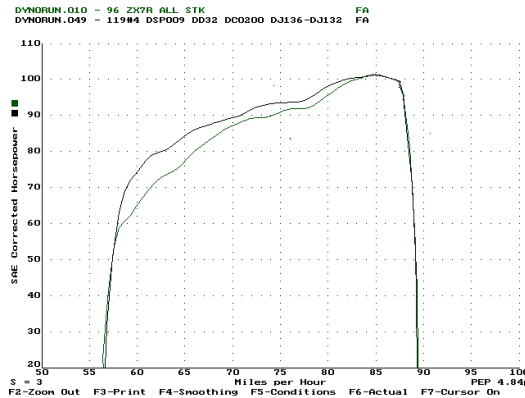

This graph shows a typical gain with a Dynojet jet kit.

WARNING

**NO SMOKING!
 NO OPEN FLAME!
 WHILE INSTALLING
 YOUR DYNOJET KIT**

Parts List

4	Main Jets	DJ132
4	Main Jets	DJ136
4	Fuel Needles	DNO119
4	Slide Springs	DSP006
4	Main Air Plugs	DCO200
4	E-Clips	DE0001
8	Adjusting Washers	DW0001
1	Tool	DT001

STAGE ONE INSTRUCTIONS

DYNOJET
E2170.001

1. Remove vacuum slides from carbs. Remove stock needles and spacers, noting order of assembly (Fig.A).
2. Install Dynojet needles on groove #4 from the top. Use all stock spacers (Fig. A). Install the small Dynojet washers above the E-clip (2 per needle). Install Dynojet slide springs (DSP006) in place of the stock springs. After installing the slides in the carbs be sure to check slide movement manually.
3. Remove the stock main jets and replace with Dynojet main jets provided. If you are running the stock exhaust install the DJ132 main jets. If you are running an aftermarket exhaust with high flow baffle use the DJ136 main jets. Be sure that the jets you are changing are the main jets.
4. Locate the main air passage (Fig. B). With the flat end facing into the carb, install the main air plugs provided (DCO200). Use the tool provided (DT0001) to tap lightly in place.
5. Locate the fuel mixture screw (Fig. C). Carefully turn the mixture screws clockwise until lightly seated, then back out 1 3/4 turns or until the best idle is achieved.

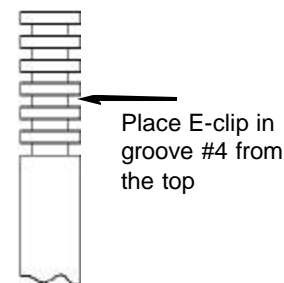

Fig. A

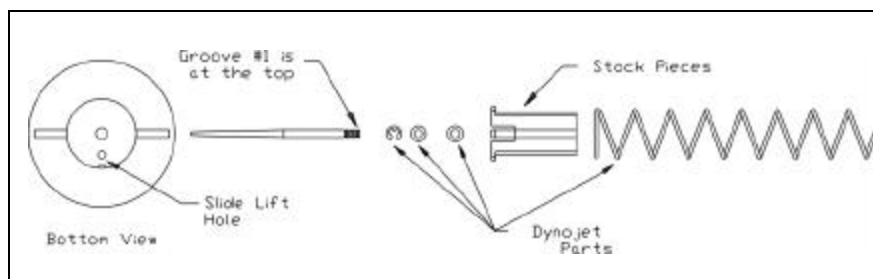

Fig. B

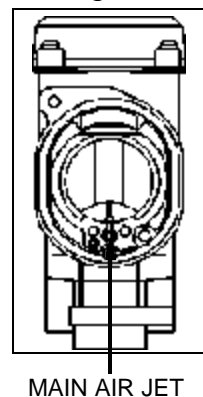

Fig. C

