

Thank you for purchasing this Dynojet kit. This kit has been developed for a motorcycle which is set to the parameters listed at the right in the "Stage" description. If your motorcycle does not meet any of these parameters please check with Dynojet before installation. For technical assistance contact your Dynojet distributor or call Dynojet U.S.A. (800)-992-4993



**E3155.001**

**European Models Only**

*1996-1998 Suzuki GSXR 600*

**Stage 1**

For mildly tuned machines using the stock air-box, with stock or K&N filter. May also be used with a good aftermarket exhaust system  
K&N filter #SU-0005

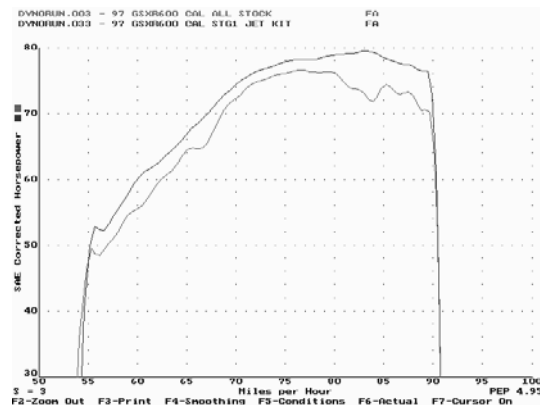

*This graph shows a typical gain with a Dynojet jet kit.*

2191 Mendenhall Dr. Suite 105  
North Las Vegas, NV 89031  
TEL: 702-399-1423  
FAX: 702-399-1431  
8am-5pm Pacific Time  
Monday through Friday

**Website Address**  
<http://www.dynojet.com>

The manufacturer and seller make no warranties express or implied which extend beyond the description of the goods contained herein. Any description of this product is for the purpose of identifying it and shall not be deemed to create an express warranty.

# WARNING

**NO SMOKING!  
NO OPEN FLAME!  
WHILE INSTALLING  
YOUR DYNOJET KIT**

<b>Parts List</b>		
2	Main Jets	DJ100
2	Main Jets	DJ102
2	Main Jets	DJ104
2	Main Jets	DJ106
2	Main Jets	DJ108
4	Fuel Needles	DNO209
4	E-Clips	DE0001
4	Adjusting Washers	DW0001
4	Main Air Jet Plugs	DCO500
4	Pilot Jets	DPJM015
1	Tool	DT001
1	Glue	DA0001

## STAGE ONE INSTRUCTIONS

**DYNOJET**  
E3155.001

1. Remove vacuum slides from carbs. Remove stock needles and spacers, noting order of assembly (Fig. A).
2. Install Dynojet needles on groove #3 from the top. Use all stock spacers (Fig. A). The small Dynojet washers are for half step increments and do not have to be installed at this time. After installing the slides in the carbs be sure to check slide movement manually before air box installation.
3. Install the Dynojet main jets provided. With slide lift restriction in place, use DJ102 main jets in the outside cylinders (1&4) and DJ100 main jets in the inside cylinders (2&3). If you are running the stock exhaust, install the DJ102 main jets in the outside cylinders (1&4) and the DJ100 main jets in the inner cylinders (2&3). If you are running an aftermarket exhaust or slip-on with a high flowing baffle, use the DJ106 main jets in the outside cylinders (1&4) and DJ104 main jets in the inner cylinders (2&3). Be sure that the jets you are changing are the main jets.
4. **For race use only.** Remove the stock pilot jets and replace with Dynojet pilot jets (DPJM015).
5. Remove carb bell mouths. Using tool provided (DT001) tap the main air jet plugs (DCO500) open end facing out, into place (Fig B). Reinstall the bell mouths. **NOTE: The main air plugs must be installed for this kit to function properly.**
6. Locate the fuel mixture screw (Fig. C). Carefully turn mixture screws clockwise until lightly seated, then back out 2-1/2 turns.

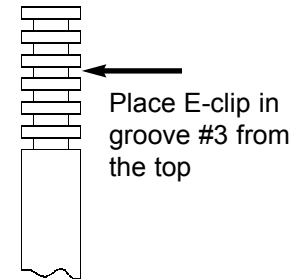

Fig. A

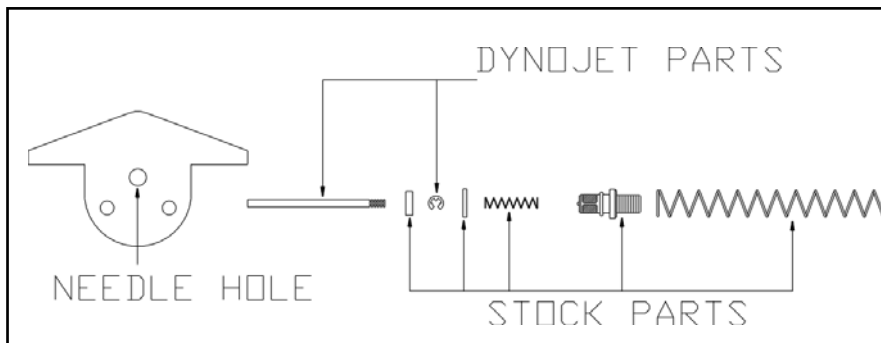
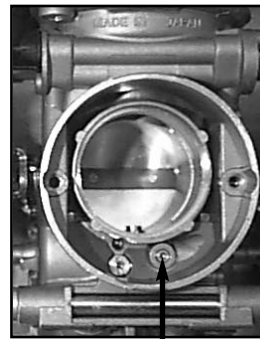
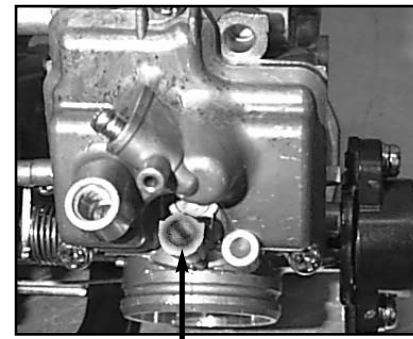

Fig. B



MAIN AIR JET

Fig. C



MIXTURE SCREW