

Thank you for purchasing this Dynojet kit. This kit has been developed for a motorcycle which is set to the parameters listed at the right in the "Stage" description. If your motorcycle does not meet any of these parameters please check with Dynojet before installation. For technical assistance contact your Dynojet distributor or call Dynojet U.S.A. (800)-992-4993

2191 Mendenhall Dr. Suite 105
North Las Vegas, NV 89031
TEL: 702-399-1423
FAX: 702-399-1431
8am-5pm Pacific Time
Monday through Friday

Website Address
<http://www.dynojet.com>

The manufacturer and seller make no warranties express or implied which extend beyond the description of the goods contained herein. Any description of this product is for the purpose of identifying it and shall not be deemed to create an express warranty.



E3160.001

European Models Only

1999-2000 Suzuki GSXR 600

Stage 1

For mildly tuned machines using the stock air-box, with stock or K&N filter. May also be used with a good aftermarket exhaust system
K&N Filter #SU-0005

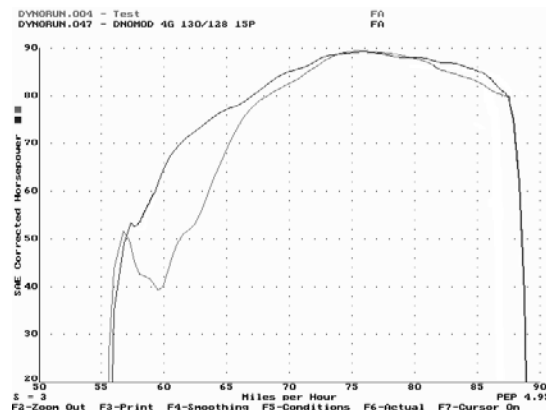

This graph shows a typical gain with a Dynojet jet kit.

WARNING

**NO SMOKING!
NO OPEN FLAME!
WHILE INSTALLING
YOUR DYNOJET KIT**

Parts List

2	Main Jets	DJ130
2	Main Jets	DJ132
2	Main Jets	DJ134
2	Main Jets	DJ136
2	Main Jets	DJ138
2	Main Jets	DJ140
2	Main Jets	DJ142
2	Main Jets	DJ144
4	Fuel Needles	DNO255
4	E-Clips	DE0001
4	Adjusting Washers	DW0001
1	Plug Drill	DD #5/32
1	Screw	DS0001
4	Pilot Jets	DPJM015

STAGE ONE INSTRUCTIONS

DYNOJET
E3160.001

1. Remove vacuum slides from carbs. Remove stock needles and spacers, noting order of assembly (Fig. A).
2. Install Dynojet needles on groove #3 from the top. Use all stock spacers (Fig. A). The small Dynojet washers are for half step increments and do not have to be installed at this time. After installing the slides in the carbs be sure to check slide movement manually.
3. Install the Dynojet main jets provided. If you are running the stock exhaust install the DJ132 main jets in the outside cylinders (1&4) and the DJ130 main jets in the inner cylinders (2&3). If you are running an aftermarket exhaust or slip-on with a high flowing baffle, use the DJ134 main jets in the outer cylinders (1&4) and DJ132 main jets in the inner cylinders (2&3). Be sure that the jet you are changing is the main jet. **NOTE:** When using a K&N filter use DJ140 & DJ142 main jets accordingly with the stock exhaust and DJ142 & DJ144 main jets with an aftermarket exhaust.
4. **FOR RACE USE ONLY:** Remove the stock pilot jets and replace with the pilot jets provided (DJPM015). This modification is not recommended for street use.
5. Locate the fuel mixture plug (Fig. B). If you see a screw head at Fig. B proceed to adjusting procedure. With the 5/32 drill bit provided carefully drill through the plugs. **NOTE:** The mixture screw is directly underneath this plug, be ready to pull back on the drill the instant you break through. Use screw provided to secure and remove this plug. Carefully turn mixture screws clockwise until lightly seated, then back out 2 1/2 turns.

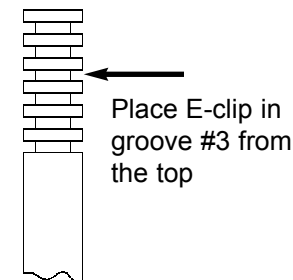

Fig. A

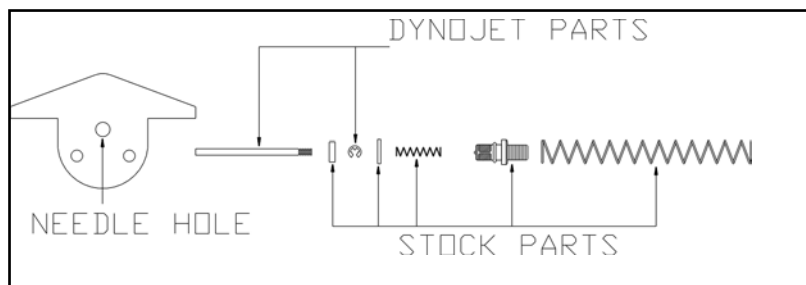
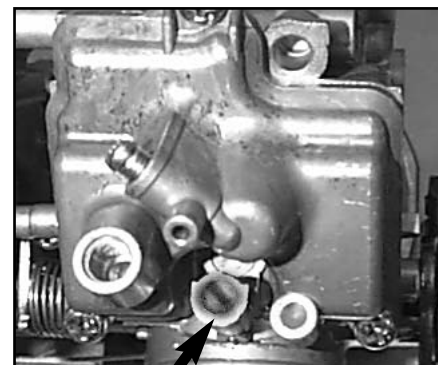

Fig. B



MIXTURE SCREW