

Thank you for purchasing this Dynojet kit. This kit has been developed for a motorcycle which is set to the parameters listed at the right in the "Stage" description. If your motorcycle does not meet any of these parameters please check with Dynojet before installation. For technical assistance contact your Dynojet distributor or call Dynojet U.S.A. (800)-992-4993

2191 Mendenhall Dr. Suite 105  
 North Las Vegas, NV 89031  
 TEL: 702-399-1423  
 FAX: 702-399-1431  
 8am-5pm Pacific Time  
 Monday through Friday

Website Address  
<http://www.dynojet.com>

The manufacturer and seller make no warranties express or implied which extend beyond the description of the goods contained herein. Any description of this product is for the purpose of identifying it and shall not be deemed to create an express warranty.



**E4135.002**

European Models Only

*1995-98 Yamaha XJR 1200 &  
 99 XJR1300*

**Stage 1**

For mildly tuned machines using the stock air-box, with stock or K&N filter. May also be used with a good aftermarket exhaust system.  
 K&N filter #YA-0082

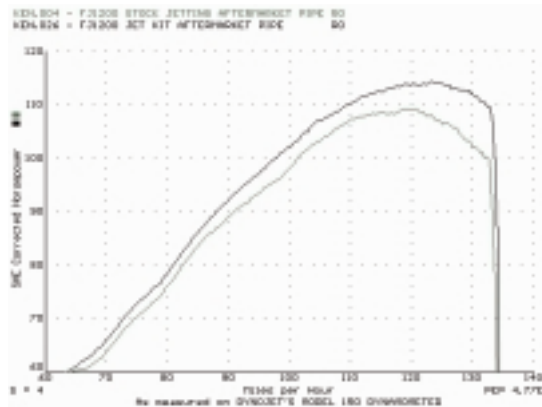

*This graph shows a typical gain with a Dynojet jet kit.*

# WARNING

**NO SMOKING!  
 NO OPEN FLAME!  
 WHILE INSTALLING  
 YOUR DYNOJET KIT**

## Parts List

4	Main Jet	DJ092
4	Main Jet	DJ096
4	Main Jet	DJ100
4	Fuel Needles	DNO356
4	E-Clips	DE0001
4	Adjusting Washers	DW0001
1	Slide Drill	DD #29

## STAGE ONE INSTRUCTIONS

1. Remove vacuum slides from carbs. Remove stock needles and spacers, noting order of assembly (Fig.A).
2. Using the drill bit provided (DD #29) enlarge the slide lift hole (Fig. A).
3. Install Dynojet needles on groove #3 from the top. Use all stock spacers (Fig. A). When installing the plastic needle spacer make sure that the pin aligns with the hole in the slide next to the needle hole. After installing the slides in carbs be sure to check slide movement manually before air box installation.
4. Install the Dynojet mains provided. If you are running the stock exhaust install the DJ096s (XJR1300 - DJ092s). If you are running an aftermarket exhaust or slip-on with a high flowing baffle, use the DJ100s (XJR1300 - DJ096s). Be sure that the jet you are changing is the main jet.
5. Locate the fuel mixture screw (Fig. B). Carefully turn mixture screws clockwise until lightly seated, then back out 2-1/2 turns or until the best idle is achieved.

**DYNOJET**

**E4135.002**

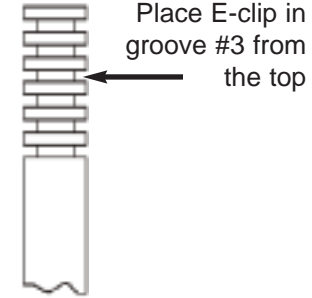

Fig. A

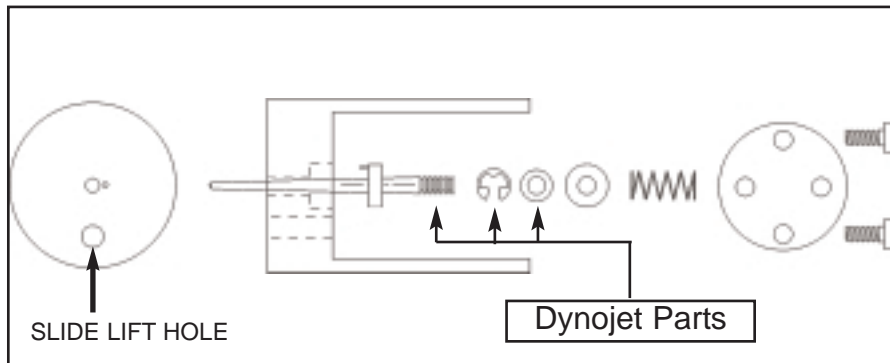

Fig. B

