

Thank you for purchasing this Dynojet kit. This kit has been developed for a motorcycle which is set to the parameters listed at the right in the "Stage" description. If your motorcycle does not meet any of these parameters please check with Dynojet before installation. For technical assistance contact your Dynojet distributor or call Dynojet U.S.A. (800)-992-4993

2191 Mendenhall Dr. Suite 105
 North Las Vegas, NV 89031
 TEL: 702-399-1423
 FAX: 702-399-1431
 8am-5pm Pacific Time
 Monday through Friday

Website Address
<http://www.dynojet.com>

The manufacturer and seller make no warranties express or implied which extend beyond the description of the goods contained herein. Any description of this product is for the purpose of identifying it and shall not be deemed to create an express warranty.



E4137.001

European Models Only

1999 Yamaha TDM850

Stage 1

For mildly tuned machines using the stock airbox, with stock or K&N filter. May also be used with a good aftermarket exhaust.
 K&N #YA-7585

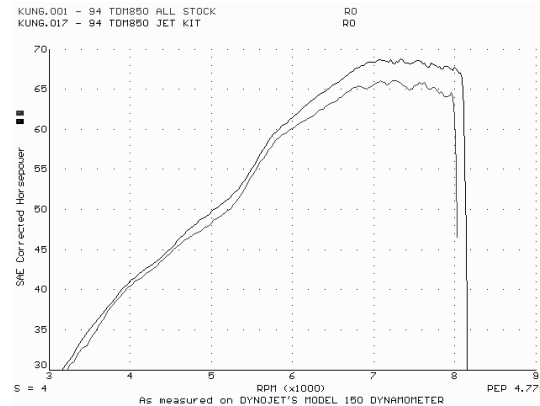

This graph shows a typical gain with a Dynojet jet kit.

WARNING

**NO SMOKING!
 NO OPEN FLAME!
 WHILE INSTALLING
 YOUR DYNOJET KIT**

Parts List

2	Main Jets	DJ140
2	Main Jets	DJ144
2	Fuel Needles	DNO709
2	Adjusting Washers	DW0001
2	E-clips	DE0001
2	Needle Springs	DSP77

STAGE ONE INSTRUCTIONS

DYNOJET
E4137.001

1. Remove vacuum slide from carbs. Remove stock needle and spacers, noting order of assembly (Fig.A).
2. Install Dynojet needles on groove #3 from the top. Use all stock spacers (Fig. A). Install the small Dynojet washers above the e-clip. After installing the slides in the carbs be sure to check slide movement manually before air box installation.

Note: The DSP77 springs do not have to be used, they are supplied in case the stock springs are misplaced. After installing the slides in the carbs, be sure to check the slide movement manually before air box installation.

3. Remove the stock main jets and replace with Dynojet mains provided. If you are running the stock exhaust install the DJ140 main jets. If you are running an aftermarket exhaust or slip-ons with high flowing baffles use the DJ144 main jets. Be sure that the jets you are changing are the main jets.
4. Locate the fuel mixture screw (Fig. B). Carefully turn the mixture screw clockwise until lightly seated, then back out 3-1/2 turns.

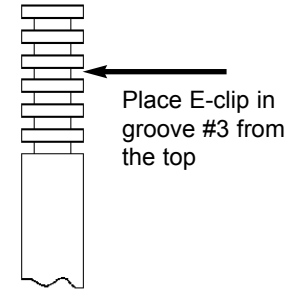

Fig. A

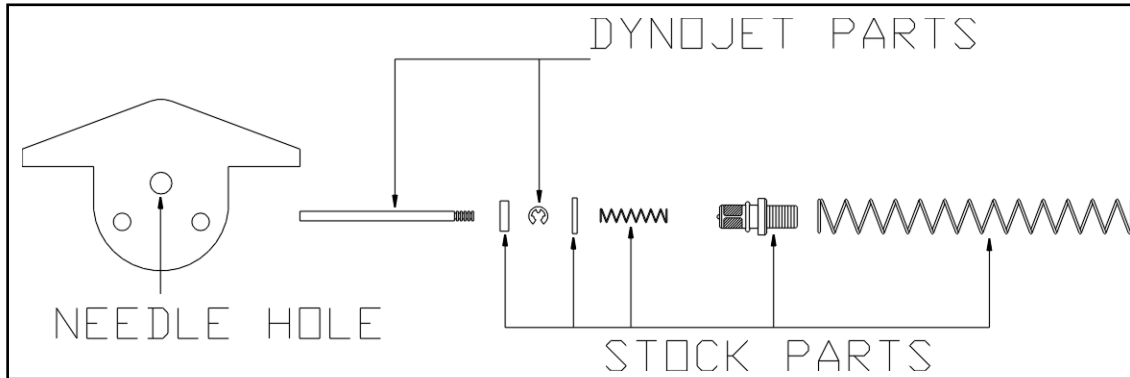
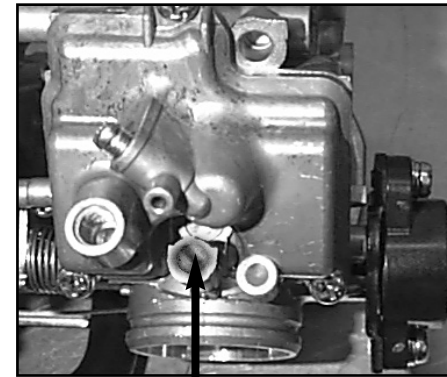

Fig. B



Fuel Mixture Screw