

Thank you for purchasing this Dynojet kit. This kit has been developed for a motorcycle which is set to the parameters listed at the right in the "Stage" description. If your motorcycle does not meet any of these parameters please check with Dynojet before installation. For technical assistance contact your Dynojet distributor or call Dynojet U.S.A. (800)-992-4993



E4138.002

European Models Only

1992-96 Yamaha XJ600 Diversion

Stage 1&3

STAGE 1

For mildly tuned machines using the stock airbox, with stock or K&N filter #YA-6092

STAGE 3

For mildly tuned machines using individual filters or velocity stacks. K&N filters #RC-1824

Both stages may also be used with a good aftermarket slip-on.

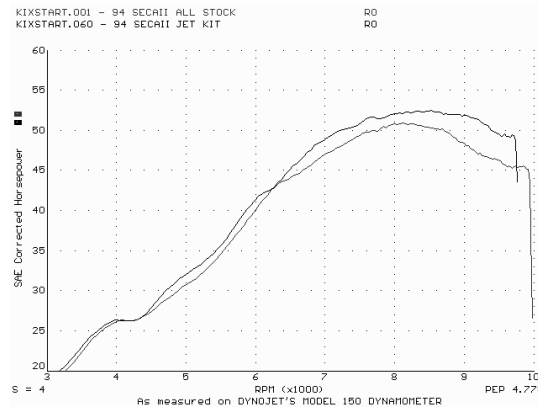

This graph shows a typical gain with a Dynojet jet kit.

WARNING

**NO SMOKING!
 NO OPEN FLAME!
 WHILE INSTALLING
 YOUR DYNOJET KIT**

2191 Mendenhall Dr. Suite 105
 North Las Vegas, NV 89031
 TEL: 702-399-1423
 FAX: 702-399-1431
 8am-5pm Pacific Time
 Monday through Friday

Website Address
<http://www.dynojet.com>

The manufacturer and seller make no warranties express or implied which extend beyond the description of the goods contained herein. Any description of this product is for the purpose of identifying it and shall not be deemed to create an express warranty.

Parts List

4	Main Jets	DJ098
4	Main Jets	DJ102
4	Main Jets	DJ128
4	Main Jets	DJ132
4	Slide Springs	DSP007
4	Fuel Needles	DNO466
4	Adjusting Washers	DW0001
4	E-Clips	DE0001

STAGE ONE INSTRUCTIONS

1. Remove the vacuum slide from the carbs. Remove the stock needles & spacers, noting order of assembly (Fig. A).
2. Install the Dynojet needles on groove #3, without the stock nylon spacer. Use all other stock spacers (Fig. A). Install the Dynojet washer above the E-clip.
3. Install the Dynojet slide springs in place of the stock slide springs.
4. Remove the stock main jets and replace with the Dynojet main jets provided. Use the DJ098 main jets with stock exhaust pipe, or use the DJ102 main jets with aftermarket header or slip-on with high flowing baffles. Be sure that the jets you are changing are the main jets.
5. Locate the Fuel Mixture screw (Fig. B). Carefully turn mixture screw clockwise until seated, then back out 2-1/2 turns.

STAGE THREE INSTRUCTIONS

1. Remove the vacuum slide from the carbs. Remove the stock needles & spacers, noting order of assembly.
2. Install the Dynojet needles on groove #3, without the stock nylon spacer. Use all other stock spacers (Fig.A.). Install the Dynojet washer above the E-clip.
3. Install the Dynojet slide springs in place of the stock slide springs.
4. Remove the stock main jets and replace with the Dynojet main jets provided. Use the DJ128 main jets with stock exhaust pipe, or use the DJ132 main jets with aftermarket header or slip-on with high flowing baffles. Be sure that the jets you are changing are the main jets.
5. Locate the Fuel Mixture screw (Fig. C). Carefully turn mixture screw clockwise until seated, then back out 2-1/2 turns.

Place E-clip in groove #3 from the top

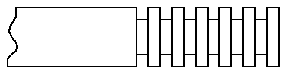

Fig. A

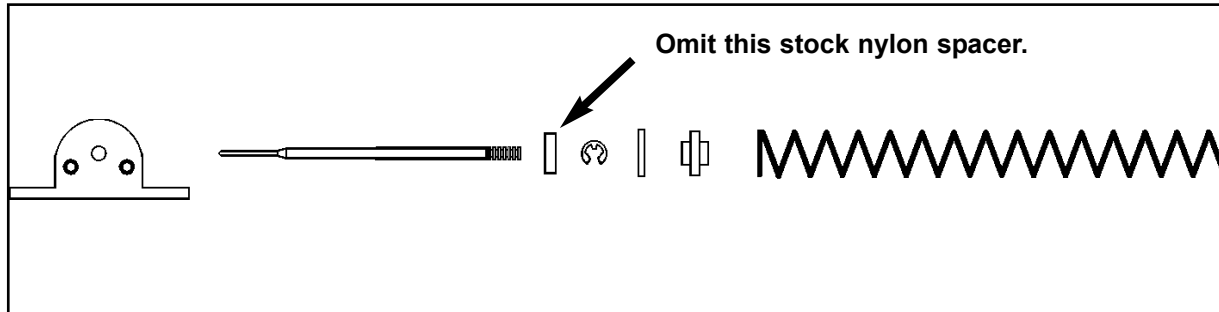

Fig. B

