



AX1600

Adventure Skid Plate
BMW GS1250

4 NE01-02-003 - Tfhc 6x25mm
11 NE01-03-001 - M6 Washers
11 NE01-04-003 - Em6f
2 NE01-01-005 - Tbhc 8x35mm
5 NE01-03-002 - M8 Wahsers
3 NE01-02-006 - Tfhc 6x40mm
3 NE01-01-014 - Tbhc 8x50mm
4 NE01-02-005 - Tfhc 6x35mm

1 PM01-04-213
1 PM01-04-214
1 PM01-04-215
1 PM01-04-216
1 PM01-04-217
1 PM01-14-001
1 NE04-01-184 (Grey sticker)



VIDEO
SCAN



1



4 Tfhc 6x35mm + 4 Em6f + 4 M6 Washers

IMPORTANT ! Make sure
to respect the way to
place each of the plastic
mounts exactly like the
following pictures

ON THE RIGHT SIDE



ON THE LEFT SIDE



2



IMPORTANT ! The « B »
part has to be placed like
picture « 2A », not like
picture « 2B »

2A

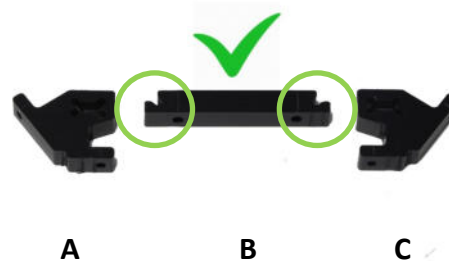

A

B

C

2B

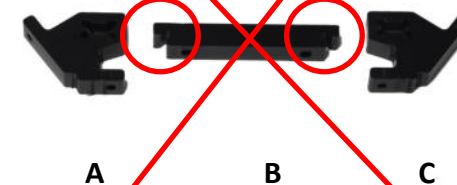

A

B

C



4 Tfhc 6x25mm + 4 Em6f + 4 M6 Washers

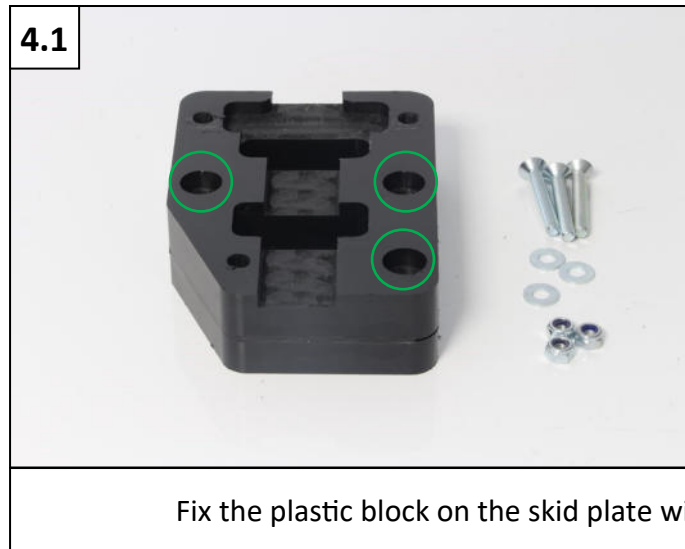

Fix the plastic block on the skid plate with 3 Tfhc 6x40mm + 3 Em6f + 3 M6 Washers

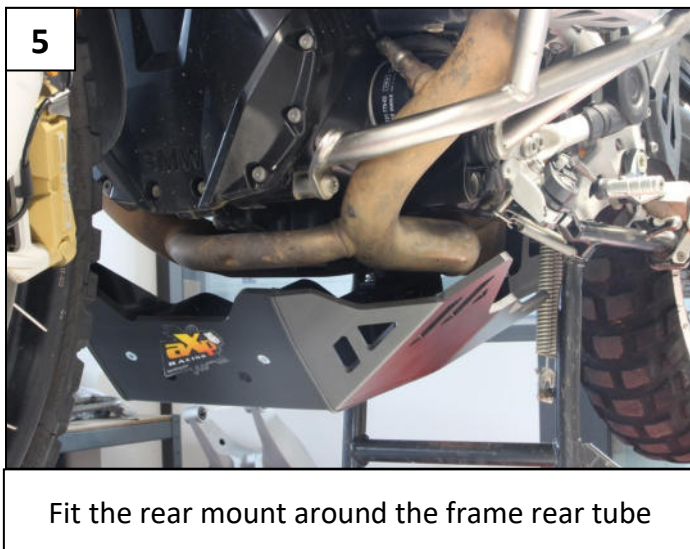
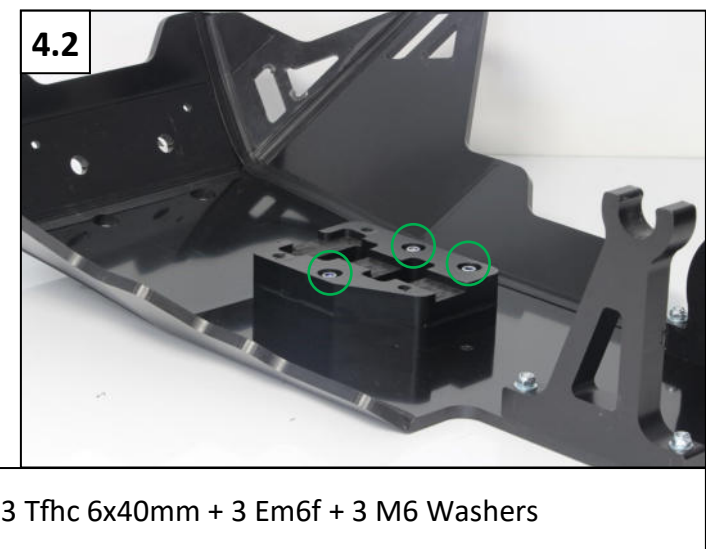

Fit the rear mount around the frame rear tube



Place the front Tbhsc 8x35mm screws with M8 Washers

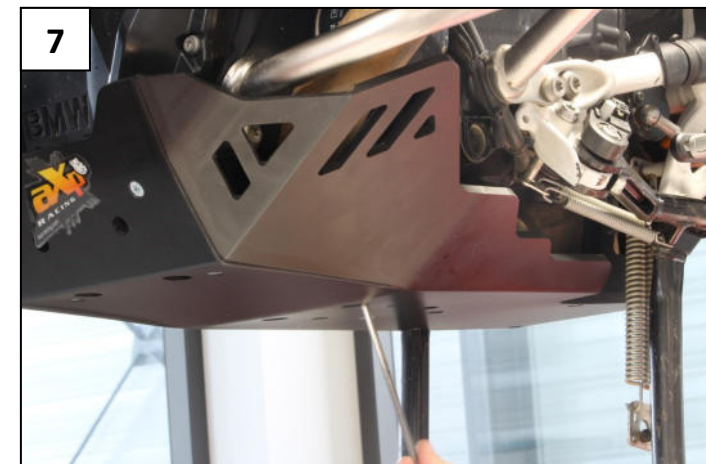

Place the 3 Tbhsc 8x50mm screws in the middle of the skid plate with M8 Washers and tight everything

YOU CAN FIND MORE CONTENT ON
OUR SOCIAL MEDIA AND FIND TUTO-
RIAL VIDEOS ON YOUTUBE

